

NOVANTA/3

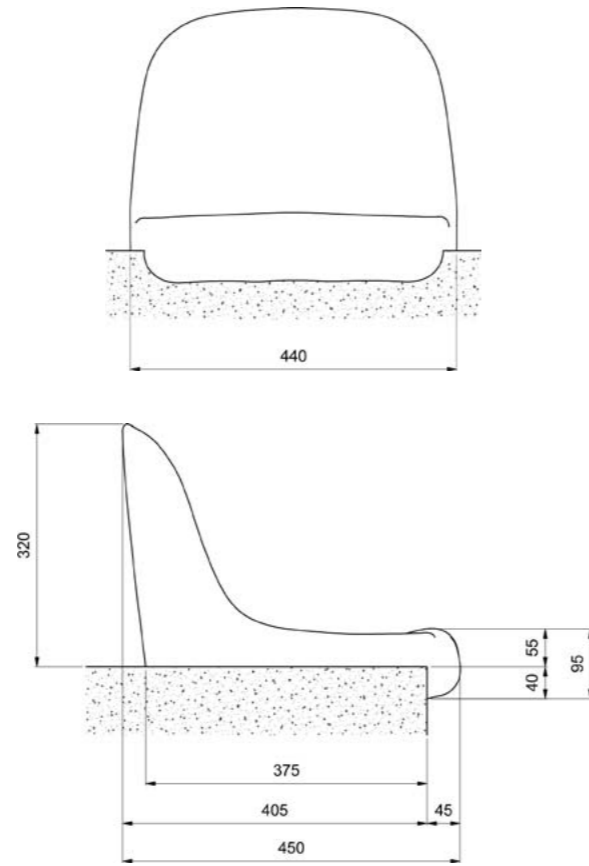

STRUCTURE

Multipurpose seat with high backrest sized for the utmost comfort and in line with FIFA and UEFA recommendations. Seat in single piece injection moulded thermoplastic without metal inserts.

Ergonomically designed for the utmost comfort for sport events' spectators.

INSTALLATION

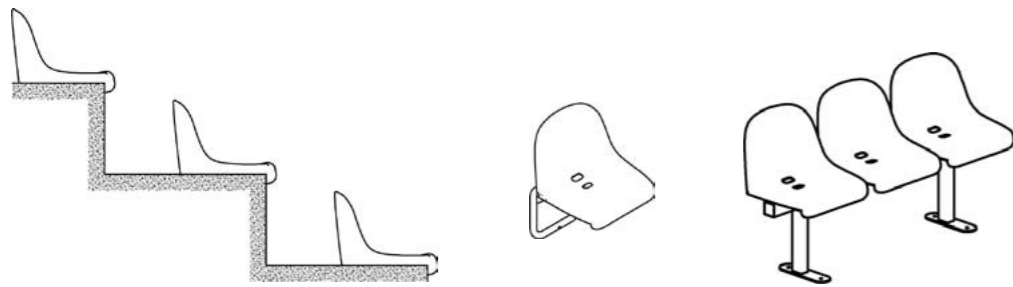

TECHNICAL SPECIFICATIONS

Material	Copolymer masterbatch mass coloured polypropylene		
Finish	Smooth, semi-gloss finish, UV stabilised		
Fixing	2 or 3 fixing points for installation on concrete steps or other types of surfaces. The fixing points are closed and protected by caps		
Unmovable	The seat rests along the entire edge, with the front flush fitted with the edge of the step. This means seats cannot be lifted up, and stops vandalism		
Numbering	Non-removable number plate		
Water drainage	The seat has hole for drainage		
Installation	The minimum dimensions of the installation centre distance must conform to regulations in force		
Available versions	Supports with metal structure to install the seats at facilities without steps, or on non-standard steps		
Certification	Standard	Class	Level
Fire resistance*	Italian CLASSE 1 Italia (DM 26/6/84 e DM 3/10/2002)	1	=
	French NFP92-501	M 2	=
	English BS5852	CRIB5	=
Resistance and durability	EN 13200 - 4 : 2007	=	4
Testing methods	EN 12727	=	4
Conformity			
FIFA and UEFA standards	EN 13200 - 4 : 2007	=	=

*Certifications referred only to fire-resitant product version.

VENELLI SEATING

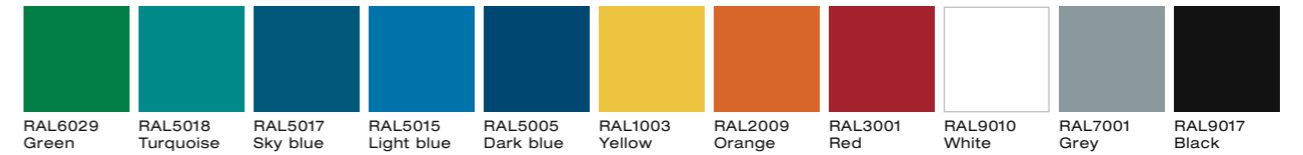

The colors are approximate. Actual colors of the products may vary slightly.

BRACKETS AND BEAMS

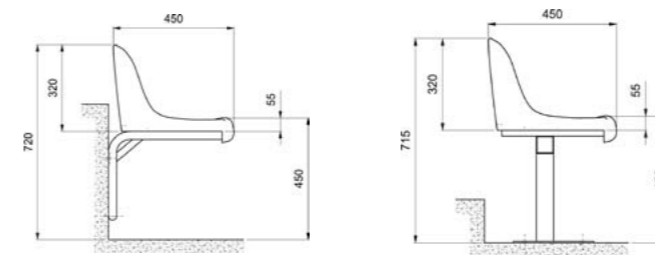

SPECIAL ACCESSORIES

NOVANTA/3 SEAT INSERTS

5 cm and 7 cm inserts the inserts make it possible to vary seating heights, when seating is not standard.

